

Cutaway Illustrations



Proper usage of these tools minimizes the potential damage to the steering wheel.

When actually removing the air bag, the person working on the wheel will most like be in a position like the one above.

However, the pictures provided in this instruction booklet may be positioned differently for clarity purposes.

1-1

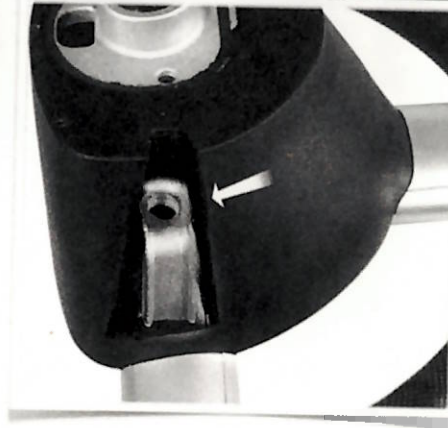

*Cutaway of access hole.
Notice hole in the metal bracket.*

Foam must be cleared out only to this point. Maximum core drill insertion is 1.5"

1-2

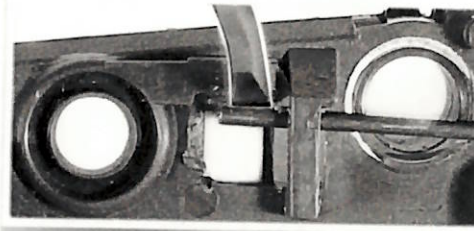

Airbag retaining spring in locked position.

1-3

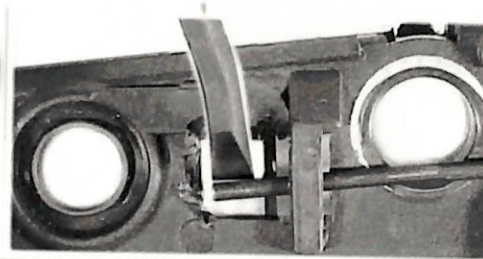

Airbag retaining spring in open position.



Volkswagen Airbag Removal Tool



Using the Core Drill



To begin, release the wheel locking mechanism and pull it down and out. Then turn the wheel so that the two silver spokes are vertical.

Using the Removal Tool



Insert removal tool with the tip as close to the rim side of the hole as possible. Then engage tool tip behind spring.

(see illustration 1-2 on reverse side)



The ONLY purpose of the core drill is to remove excess foam from the square hole to a maximum depth of 1.5"

WARNING - Core drill is extremely sharp.

As you are inserting core drill into square access hole, rotate left to right repeatedly, while advancing it towards the airbag. (see picture 3 to the right).



Pull the handle towards the rim, pushing the spring to full, open position. Repeat steps 1-6 for 2nd hole.

(see illustration 1-3 on reverse side)

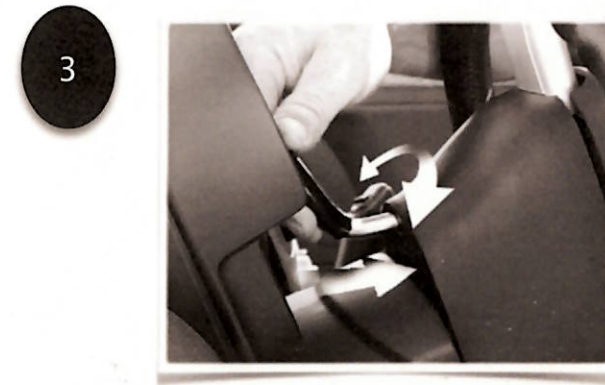

The core drill must clean the foam from the sides of the foam access hole. When the core drill touches metal **STOP!**

Any further contact with metal will permanently damage and/or break the hardened core drill.

(see illustration 1-1 on reverse side)



Slight pressure on unlatched side of the airbag may be required to fully release the air bag in step 6 when working on second hold. Once spring is disengaged, remove airbag.